

12" Enviroguard™

Ordering Information

ELP - W 0 - 4 I 232T I

SERIES

ELP - Prismatic Acrylic
ELA - Aluminum

ENCLOSURE

W - Enclosed Wet
E - Enclosed Damp
O - Open Damp
R - Open Wet

SIZE

0-12"
1-16"
2-22"
5-25"

REFLECTOR

1 - White Aluminum
2 - Anodized Aluminum
3 - Soft-Glo Acrylic
4 - Clear Prismatic Acrylic
5 - Custom Finish
6 - Hi-Impact Acrylic

BALLAST COVER TYPE

1 - White Aluminum
2 - Anodized Aluminum
3 - Custom Finish
7 - Non-Stick Finish (Food Processing)

VOLTAGE

1 - 120
2 - 277 D - Dual HID 120/277
3 - 347 M - Multi HID

LAMP WATTAGE & TYPE 12 INCH

126T - 1 LT 26W Triple Tube
226T - 2 LT 26W Triple Tube
132T - 1 LT 32W Triple Tube
232T - 2 LT 32W Triple Tube
142T - 1 LT 42W Triple Tube
242T - 2 LT 42W Triple Tube *
157Q - 1 LT 57W Quad Tube
160H - 1 LT 60W PLH
060I - 1 LT 60W Incandescent
075I - 1 LT 75W Incandescent
100I - 1 LT 100W Incandescent
050M - 1 LT 50W Metal Halide
070M - 1 LT 70W Metal Halide
100M - 1 LT 100W Metal Halide

Note: HID Lamps - consult manufacturer's data to specify lamp suitable for open or enclosed fixtures. May require special socket — Consult Factory.

Notes:

- All 12", 16" and 22"/25" with hose or NSF option have lens factory installed. Otherwise field installed. See SL option.
 - All fixtures listed for 40°C unless noted.
- * Fixture has vented ballast cover (available for damp location only). QL units suitable for 30°C.

Dimensions

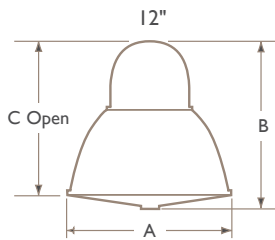

REFL. DIA	DIM. A	DIM. B	DIM. C
12" DIA.	12 7/16"	14 1/2"	13 3/8"

GN1, GN2

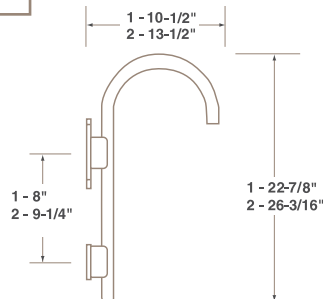

Guth utilized the services of U.L. and ETL for listing products. Specifications and data are subject to change without notice.

JOB	TYPE
CATALOG NUMBER	
LAMP	
NOTES	

Options

Electrical

"SSF" - Slow Blow Fuse - Fluorescent and HID
"CKT" - Multi Circuit Switching - consult factory
"DIM" - Dimming Fluorescent Ballast - consult factory
"SQ" - Super Quiet Potted HID Ballast

Custom Finishes

Paint - Tiger Drylac Standard - consult factory
Color Anodizing - Consult factory
Reflector Color - (plastic or aluminum) - consult factory
Plating - Consult factory (n.a. on 22" and 25")

Listings

"NSF" - NSF International Label (with "W" Enclosure)
"HOSE" - Suitable for Hosedown Label (with "W" Enclosure)

Mountings

"LHCP-120" - Loop Hanger, 6' White Cord and Molded Plug
"LHCP-277" - Loop Hanger, 6' White Cord and Twist Lock Plug
"LH-PT" - Loop Hanger Cord Set with 3' Pigtails
"WLP" - 6' Cord, Wet Location Plug and Receptacle
"CS_" - I.P. Stem with White Swivel Canopy
Specify length 3" to 96" ()
"WCC" - 6' White Cord and White Canopy (12" damp unit only)
"BCC" - 6' Black Cord and Black Canopy (12" damp unit only)
"WCW" - 6' White Curly Cord, steel cable and canopy (damp only)
"BCW" - 6' Black Curly Cord, steel cable and canopy (damp only)
"BCA" - 6' Black Cord, 10' aircraft cable and canopy
"WCA" - 6' White Cord, 10' aircraft cable and canopy

Optics

"SL" - Lens factory glued w/o clips (22" and 25")

Safety

"BEF" - 90 min. Fluorescent Battery Back-up Bodine CF-94 (1 LAMP 25°C)
"BEF-X" - consult factory for increased battery capacities
"ISL" - Instant Standby Quartz (16", 22" and 25" only)
"DISL" - Delay Instant Standby Quartz (22" and 25" only)
"IE" - Emergency Quartz Socket 120V only (16", 22" and 25" only)
"BRC" - Safety Chain and Hanger
"WG" - Wire Guard

Mounting Accessories

"GN1" - 1/2" diameter aluminum Gooseneck - 12"
"GN2" - 1/2" diameter aluminum Gooseneck - 16" and 22" units only
"BKT4" - Quad fixture mounting bracket - consult factory
"BKT2" - Twin fixture mounting bracket - consult factory