

# 16" Enviroguard™

## Ordering Information

**ELP - W 0 - 4 I 432T I**

### SERIES

ELP - Prismatic Acrylic  
ELA - Aluminum

### ENCLOSURE

W - Enclosed Wet  
E - Enclosed Damp  
O - Open Damp  
R - Open Wet

### SIZE

0-12"  
1-16"  
2-22"  
5-25"

### REFLECTOR

1 - White Aluminum  
2 - Anodized Aluminum  
3 - Soft-Glo Acrylic  
4 - Clear Prismatic Acrylic  
5 - Custom Finish  
6 - Hi-Impact Acrylic

### BALLAST COVER TYPE

1 - White Aluminum  
2 - Anodized Aluminum  
3 - Custom Finish  
7 - Non-Stick Finish (Food Processing)

### VOLTAGE

1 - 120  
2 - 277 D - Dual HID 120/277  
3 - 347 M - Multi HID

### LAMP WATTAGE & TYPE 16 INCH

426T - 4 LT 26W Triple Tube  
332T - 3 LT 32W Triple Tube  
432T - 4 LT 32W Triple Tube  
342T - 3 LT 42W Triple Tube  
442T - 4 LT 42W Triple Tube  
257Q - 2 LT 57W Quad Tube  
270Q - 2 LT 70W Quad Tube  
285H - 2 LT 85W PLH  
150H - 150W H.P.S.  
175M - 175W M.H.  
175 P - 175 Pulse Start M.H.  
85QL - 1 LT 85W Induction lamp (120V)\*  
200I - Incandescent

Note: HID Lamps - consult manufacturer's data to specify lamp suitable for open or enclosed fixtures. May require special socket — Consult Factory.

### Notes:

- All 12", 16" and 22"/25" with hose or NSF option have lens factory installed. Otherwise field installed. See SL option.
  - All fixtures listed for 40°C unless noted.
- \* Fixture has vented ballast cover (available for damp location only). QL units suitable for 30°C.

## Dimensions

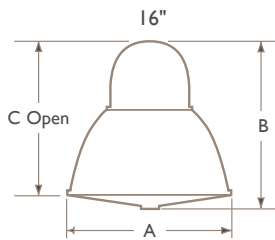

REFL. DIA	DIM. A	DIM. B	DIM. C
16" DIA.	16 1/8"	19"	17 5/8"

### GN1, GN2

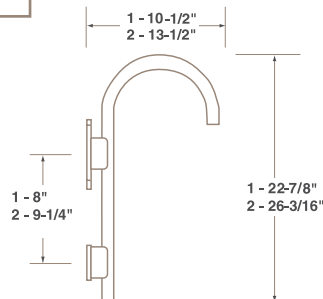

Guth utilized the services of U.L. and ETL for listing products. Specifications and data are subject to change without notice.

JOB	TYPE
CATALOG NUMBER	
LAMP	
NOTES	

## Options

### Electrical

"SSF" - Slow Blow Fuse - Fluorescent and HID  
"CKT" - Multi Circuit Switching - consult factory  
"DIM" - Dimming Fluorescent Ballast - consult factory  
"SQ" - Super Quiet Potted HID Ballast

### Custom Finishes

Paint - Tiger Drylac Standard - consult factory  
Color Anodizing - Consult factory  
Reflector Color - (plastic or aluminum) - consult factory  
Plating - Consult factory (n.a. on 22" and 25")

### Listings

"NSF" - NSF International Label (with "W" Enclosure)  
"HOSE" - Suitable for Hosedown Label (with "W" Enclosure)

### Mountings

"LHCP-120" - Loop Hanger, 6' White Cord and Molded Plug  
"LHCP-277" - Loop Hanger, 6' White Cord and Twist Lock Plug  
"LH-PT" - Loop Hanger Cord Set with 3' Pigtails  
"WLP" - 6' Cord, Wet Location Plug and Receptacle  
"CS" - I.P. Stem with White Swivel Canopy  
Specify length 3" to 96" ( )  
"WCC" - 6' White Cord and White Canopy (12" damp unit only)  
"BCC" - 6' Black Cord and Black Canopy (12" damp unit only)  
"WCW" - 6' White Curly Cord, steel cable and canopy (damp only)  
"BCW" - 6' Black Curly Cord, steel cable and canopy (damp only)  
"BCA" - 6" Black Cord, 10' aircraft cable and canopy  
"WCA" - 6' White Cord, 10' aircraft cable and canopy

### Optics

"SL" - Lens factory glued w/o clips (22" and 25")

### Safety

"BEF" - 90 min. Fluorescent Battery Back-up Bodine CF-94 (1 LAMP 25°C)  
"BEF-X" - consult factory for increased battery capacities  
"ISL" - Instant Standby Quartz (16", 22" and 25" only)  
"DISL" - Delay Instant Standby Quartz (22" and 25" only)  
"IE" - Emergency Quartz Socket 120V only (16", 22" and 25" only)  
"BRC" - Safety Chain and Hanger  
"WG" - Wire Guard

### Mounting Accessories

"GN1" - 1/2" diameter aluminum Gooseneck - 12"  
"GN2" - 1/2" diameter aluminum Gooseneck - 16" and 22" units only  
"BKT4" - Quad fixture mounting bracket - consult factory  
"BKT2" - Twin fixture mounting bracket - consult factory