



**FLUORESCENT ENERGY  
REDUCTION SYSTEM**

# **SUPER ILLUMINATOR™ 2**

**Enviroguard™ Family**

- **25% More Useable Light**
- **Cooler 40°C Operation**
- **Acrylic Reflectors**
- **Up To 39% Less Glare**

# **GUTH®**

**LIGHTING FOR DEMANDING ENVIRONMENTS**

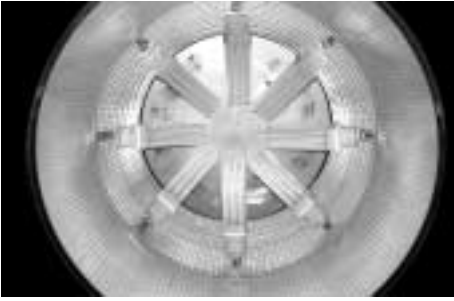

Optics and lamp orientation.

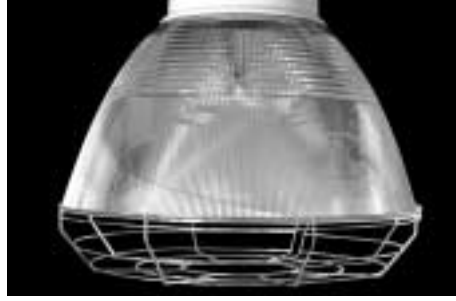

Wide Guard.



Wire Guard with lens.

## FEATURES & BENEFITS

### Mechanical

- Aluminum construction
- 2 mil polyester powder paint per ASTM B-117
- 3/4" threaded entry
- Tool free re-lamping
- Dirt resistant shape
- Up to 8 CFL lamps
- Horizontal lamping

### Optical/Lamps

- More usable light
- 1.35 to 1 spacing
- 82% color accuracy
- 86% lumen maintenance
- Constant lamp lumens (25-60°C)
- 15,000-20,000 hour life CFL's

### Electrical

- 10% THD electronic ballast
- Instant on
- Lamp switching
- Dimmable
- Step Dimming
- Quiet operation
- -22° F starting (PLH CFL's)

### Listings

- ETL to UL 1598 at 40°C

### Limited Warranty

- 5 years material and workmanship
- 5 years electronic ballast



Prismatic lens.

## DESIGN GUIDE

Lamp & Number	Lamp Lumens	Fixture Efficiency	0-60° Lumens	Watts	Rated Life	Dimming
8-42 CFL	3,200 x 8	78%	14,431	372	15,000	Y
4-57 CFL	4,300 x 4	89%	13,012	252	15,000	Y
4-70 CFL	5,200 x 4	88%	15,558	304	15,000	Y
3-60 CFL	4,000 x 3	89%	8,990	206	20,000	Step
3-85 CFL	6,000 x 3	88%	13,595	291	20,000	Step
3-120 CFL	9,000 x 3	90%	20,655	408	20,000	Step

## SUPER ILLUMINATOR PROJECTS

- Baker City Armory, OR
- Berkeley Dance Studio, CA
- Camp Pendleton, CA
- Scott Paper, CN
- Toyota Manufacturing, WV
- Hepburn Lycoming Elementary, PA
- Universal Church of Christ, OH
- York Central High School, PA
- MEC Offices, NV
- Mt Zion Church, OH
- Tulane University, LA
- Cox Elementary, GA
- Glad Tidings Church, LA

# Mechanical Design Increases Component Life

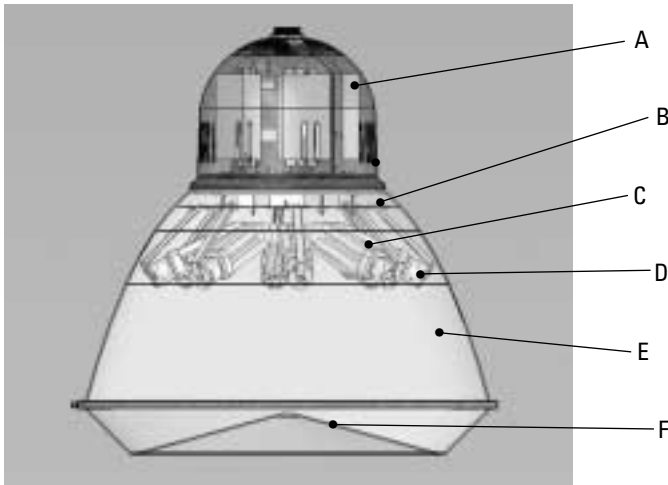

8-42W CFL with Enclosed Acrylic Reflector and Vented Top ETL Test Results at 40°C (104° F) Ambient			
	Part	Maximum Temperature	Measured Temperature
A	Ballast	90°C	73.5°C
B	Reflector Top	90°C	81°C
C	Lamp Base	140°C	117°C
D	Socket	130°C	86°C
E	Reflector Wall	90°C	75°C
F	Lens Wall	90°C	75°C

# Optical Design Increases Visibility and Reduces Glare

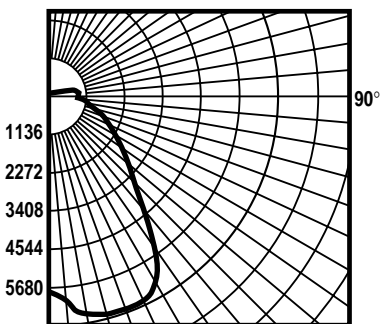

Report No. 12929

0°-60° Lumens - 14,431  
 60°-90° Lumens - 2525  
 90°-180° Lumens - 3001

Comparison of Competitive Optical Designs				
	Zone	GUTH Lumens	Brand X Lumens	Brand Y Lumens
Useful Light	0-60°	14,431	11,341	10,248
Glare	60°-90°	2525	4103	3294
Uplight	90°-180°	3001	5616	3931



\* Super Illuminator™ 2 is a registered trademark of Guth Lighting and is patent pending.

# PHOTOMETRICS

## Coefficient of Utilization 8-42 Watt 25" Open Acrylic Reflector SI-O5-4N-842T

Ceiling Refl.	80%			50%			10%		
Wall Refl.	50	30	10	50	30	10	50	30	10
RCR	20% Effective Floor Cavity Reflectance								
0	.90	.90	.90	.80	.80	.80	.69	.69	.69
1	.80	.77	.74	.72	.70	.68	.62	.61	.60
2	.72	.67	.63	.65	.61	.58	.57	.54	.53
3	.65	.59	.55	.59	.55	.52	.52	.49	.47
4	.59	.53	.49	.54	.49	.46	.48	.45	.42
5	.53	.47	.43	.49	.44	.41	.44	.40	.38
6	.49	.43	.39	.45	.40	.37	.40	.37	.34
7	.45	.39	.35	.41	.37	.33	.37	.34	.31
8	.41	.35	.31	.38	.33	.30	.34	.31	.28
9	.37	.32	.28	.35	.30	.27	.31	.28	.25
10	.34	.29	.25	.32	.27	.24	.29	.25	.23

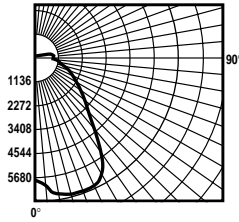

Report No. 12929

S/MH Ratio 1.35  
Total Lamp Lumens 25,600  
Fixture Efficiency 78%

0°-60° Lumens - 14,431  
60°-90° Lumens - 2525  
90°-180° Lumens - 3001

## DIMENSIONS

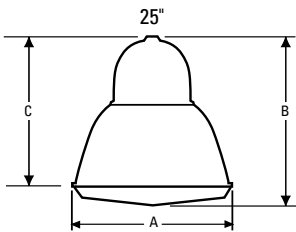

REFL. DIA	DIM. A	DIM. B	DIM. C
25"	25 3/8"	25 3/4"	23"

## OPTIONS

### Electrical

- "/SFF" – Slow Blow Fixture Fuse
- "/DIM" – Dimming Ballast – consult factory
- "/XCKT" – Multi Circuit Wiring – consult factory

### Mountings

- "/LHCP-120" – Loop Hanger, 6' White Cord and NEMA 5-15 Molded Plug
- "/LHCP-277" – Loop Hanger, 6' White Cord and NEMA L11-15 Twist Lock Plug
- "/LH-PT" – Loop Hanger Cord Set with 3' Pigtales
- "/CS\_" – I.P. Stem with 45° White Swivel Canopy. Specify Length 3" to 72" (L)

### Safety

- "/BEF" – 90 min. Fluorescent Battery Back-up - Consult factory.
- "/BRC" – Safety Chain
- "/WG" – Wire Guard
- "/LVR-25" – Parabolic Louver
- "/WGC" – Wire Guard Cage

## ORDERING INFORMATION

**SI2 O 5 - 4 N 1 - 842T D**

<p><b>SERIES</b> SI2 – Super Illuminator™2</p> <p><b>ENCLOSURE</b> E – Enclosed Damp O – Open Damp</p> <p><b>SIZE</b> 5 – 25"</p>	<p><b>REFLECTOR</b> 3 – Soft Glow Acrylic 4 – Clear Prismatic Acrylic 6 – Hi-Impact Acrylic</p> <p><b>LENS</b> N – None D – Dropped Prismatic lens</p> <p><b>BALLAST COVER</b> 1 – White Aluminum 2 – Anodized Aluminum 3 – Custom Finish</p>	<p><b>VOLTAGE</b> D – 120/277</p> <p><b>LAMPING</b> 6-42T – 6LT 42W Triple Tube 8-42T – 8LT 42W Triple Tube 4-57Q – 4LT 57W Quad Tube 4-70Q – 4LT 70W Quad Tube 3-60H – 3 LT 60W PLH 3-85H – 3 LT 85W PLH 3-120H – 3LT 120W PLH</p>
---------------------------------------------------------------------------------------------------------------------------------------------------	-------------------------------------------------------------------------------------------------------------------------------------------------------------------------------------------------------------------------------------------------------------------------------	---------------------------------------------------------------------------------------------------------------------------------------------------------------------------------------------------------------------------------------------------------------------

### Project Name:

Type	Catalogue Number	Lamp	Comments